

PLAN OF BORED PILE 500 DIA

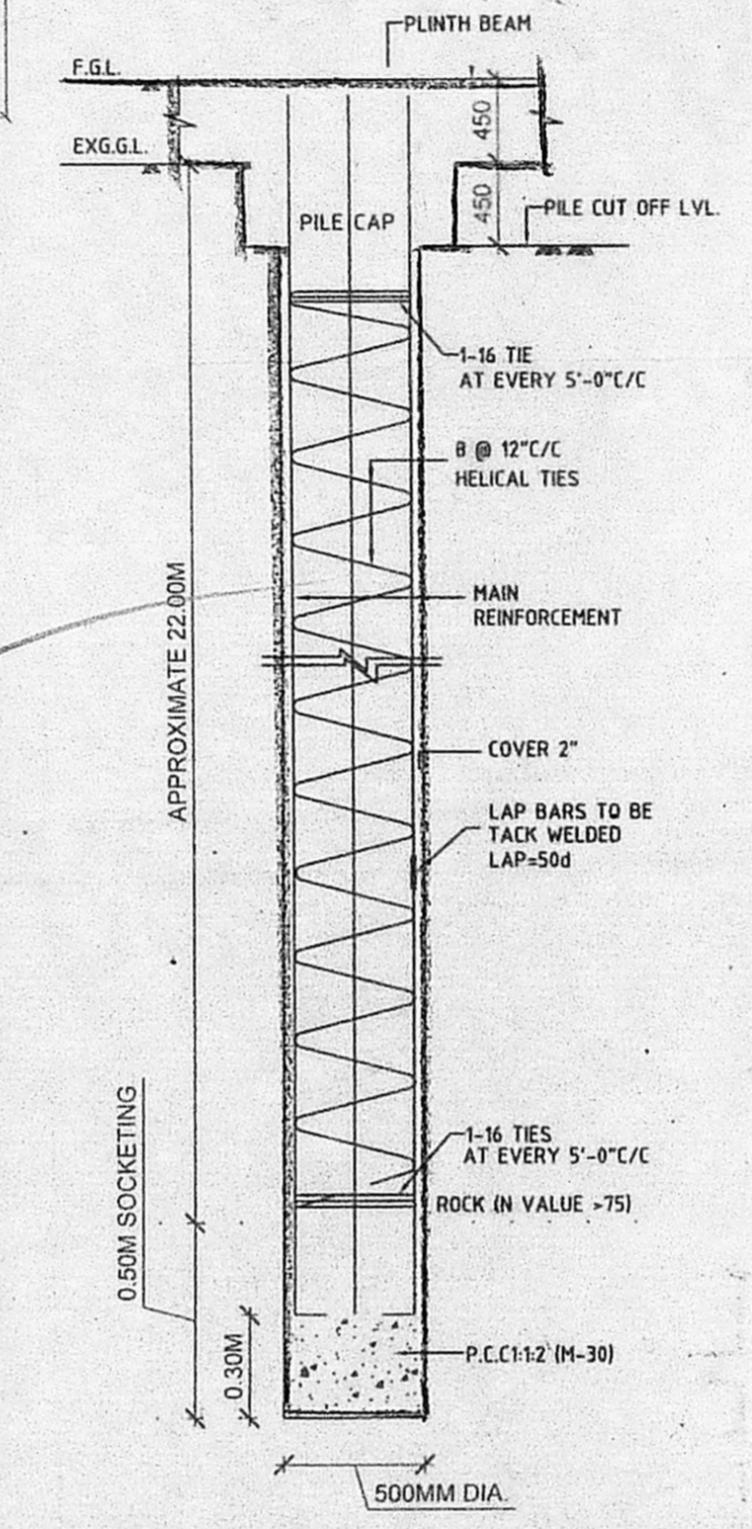

KEY PLAN (N.T.S)

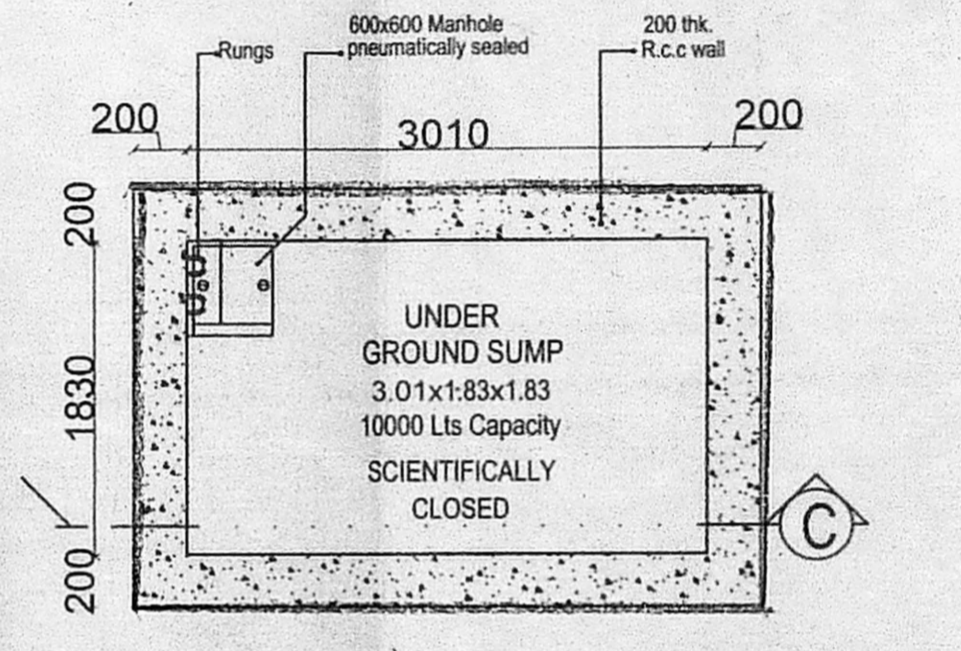
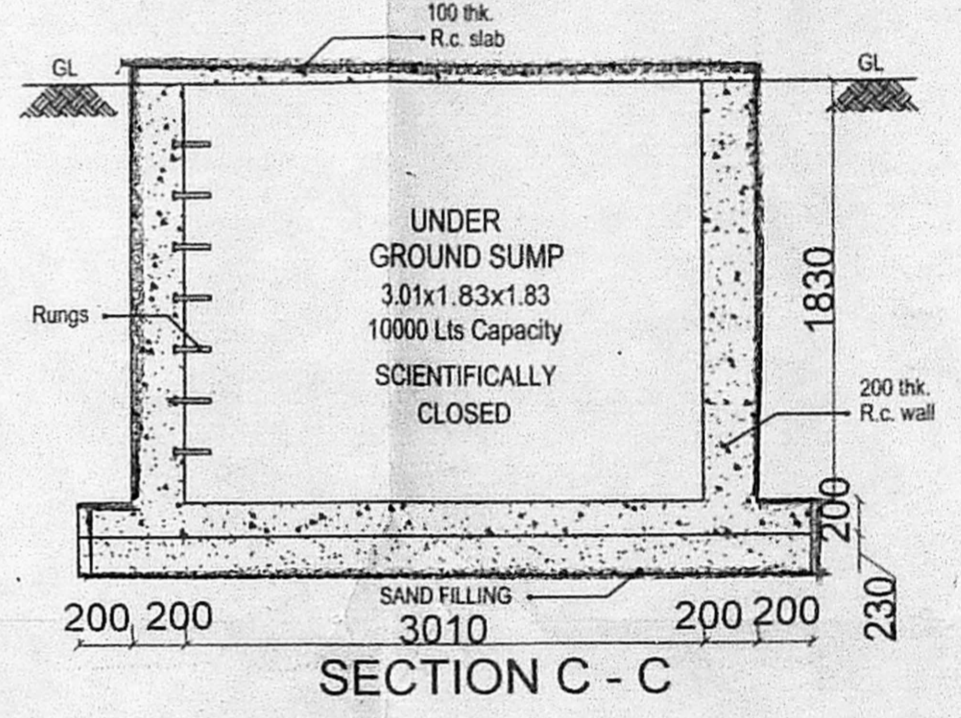

TYPICAL UNDER GROUND SUMP PLAN For Sullage, Domestic, Rain water harvesting

TYPICAL VERTICAL SECTION OF BORED PILE M-30 WITH 380KG/CUM

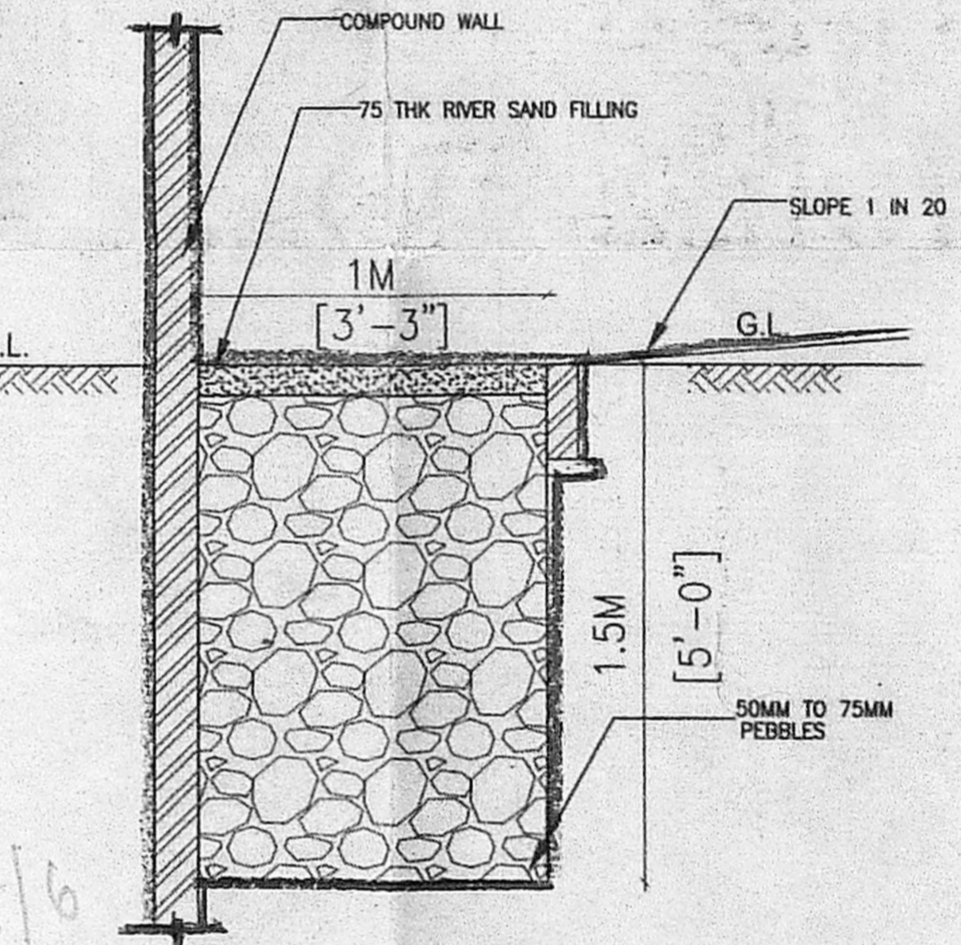

PERCOLATION TRENCH SECTION

DWARF WALL DETAIL

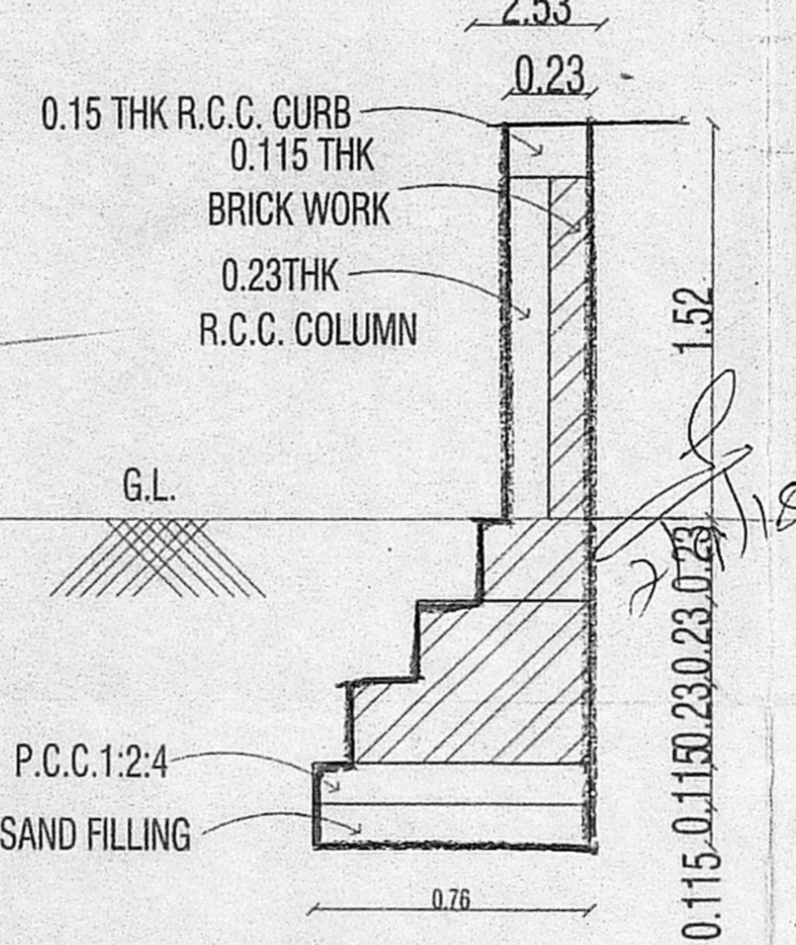

அலுவலகப் படி
 திட்ட வரைபட அனுமதி எண்
 ...
 இவ்வலுவலகக் கடித எண் ...
 உறுப்பினர் செயலருக்காக
 சென்னைப் பெருந்தார் வளர்ச்சிக் குறும்பம்,
 சென்னை - 600 008.

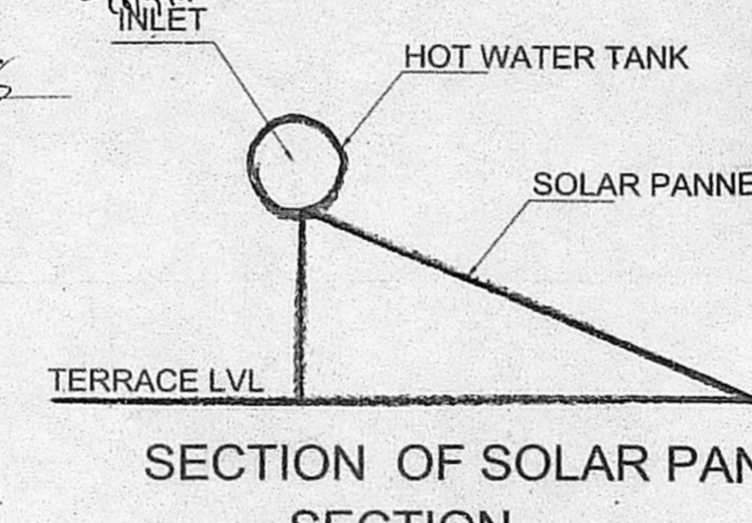

SECTION OF SOLAR PANEL

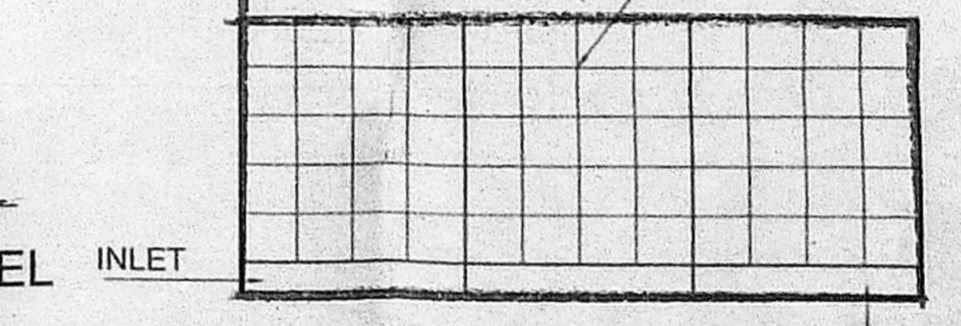

PLAN OF SOLAR PANEL WATER HEATING SYSTEM

LAND LEFT FOR STREET ALIGNMENT PORTION - 224.41 SQ.M
 ALREADY GIFTED TO CMDA WIDE FILE NO: B3/5168/15
 DATED: 30-08-2016
 PLANNING PERMIT NO: B3/SPL.BLDG/186-AB/2016
 GIFT DEED DOC NO: 1082 DATED: 14-01-2016

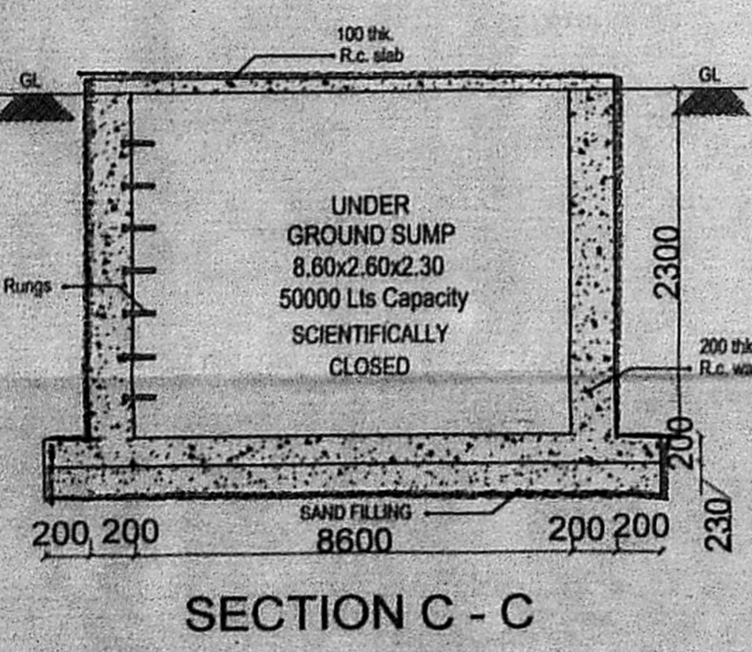

SECTION C - C

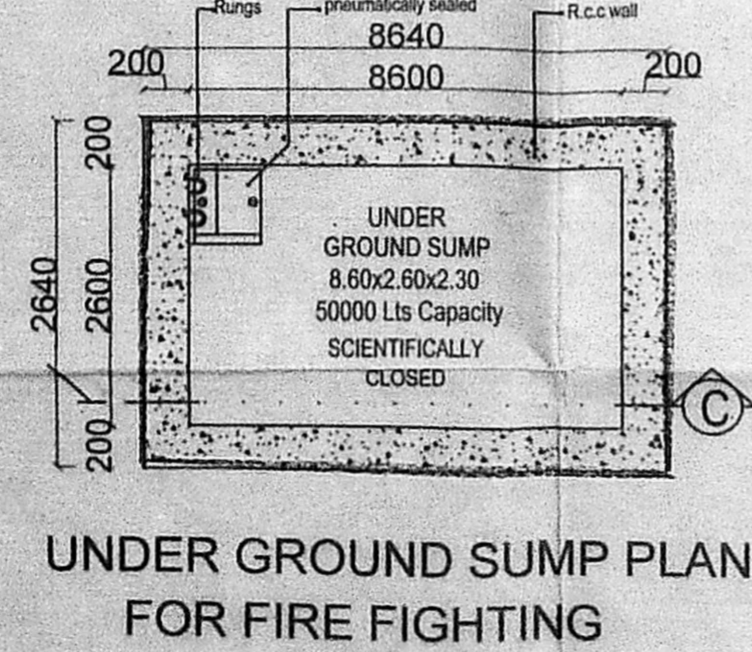

UNDER GROUND SUMP PLAN FOR FIRE FIGHTING

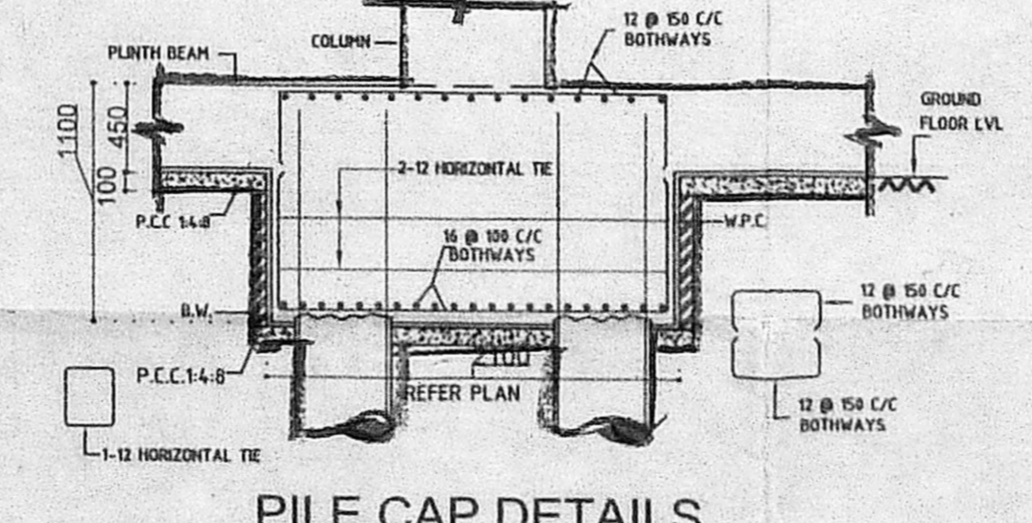

PILE CAP DETAILS

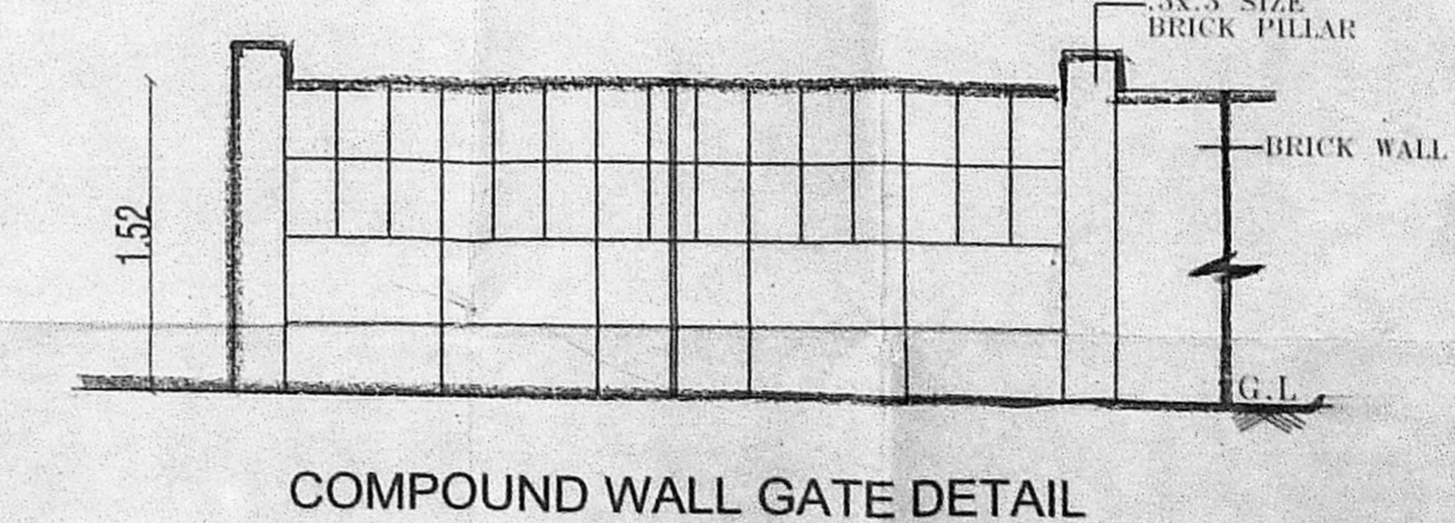

COMPOUND WALL GATE DETAIL (3.5 M WIDE)

TITLE:-	LEGEND	AREA STATEMENT	SQ.M	SPECIFICATION :-	APPLICANT:	ARCHITECT:
REVISED PLAN FOR THE EXISTING CONSTRUCTION OF BASEMENT FLOOR (PART) + STILT + 4 FLOORS COMMERCIAL (HOTEL CUM LODGE) BUILDING AT DOOR NO:868, C.T.H.ROAD,PADI,CHENNAI-50. IN OLD S.NO:321/2A2B,2C1A PT,2C2PT,2C3PT AND 2C4PT.T.S NO:20,26/2,25,BLOCK NO:04, WARD NO:1 OF PADI VILLAGE,AMBATTUR TALUK, GREATER CHENNAI CORPORATION. DIVISION NO: 87, ZONE NO: 07 EARLIER APPROVED PLANNING PERMIT NO: B3/SPL.BLDG/186-AB/2016 FILE NO: B3/5168/15 DATED: 30-08-2016	EXISTING BUILDING	FIRST FLOOR	300.66	1. R.C.C. 1:2:4 COLUMN FOUNDATION		
	EXISTING ROAD	SECOND FLOOR	311.42	2. SAND FILLING IN FOUNDATION AND BASEMENT		
	SITE BOUNDARY	THIRD FLOOR	311.42	3. P.C.C. 1:4:8 IN FOUNDATION AND BASEMENT		
	AREA STATEMENT	FORTH FLOOR	311.42	4. BRICK WORK IN CM 1:5 FOR BASEMENT, SUPER-STRUCTURE AND PARAPET WALL		
	PLOT EXTENT (AS PER DOCUMENT)	EXCESS NON FSI	6.66	5. R.C.C. LINTELS, BEAMS AND SLABS IN 1:2:4		
	PLOT EXTENT (AS PER PATTA)	TOTAL	1241.58	6. WEATHERING COURSE IN BRICK JELLY LIME CONCRETE MORTAR WITH 2 COURSES OF PRESSED TILES LAID TO SLOPE		
	PLOT EXTENT (AS PER SUPERIMPOSED AREA)	F.S.I	1.10	7. PLASTERING IN CM 1:4		
	LAND GIFTED FOR ROAD WIDENING VIDE DOC NO:1082 DT:14/01/2016	SCALE: 1:100	DATE: 03.09.2018	8. DOORS IN TEAK WOOD AND COUNTRY WOOD		
				9. WINDOWS IN ALUMINIUM FRAMES WITH GLAZING		

V. BABU, M. Arch.
 CA/2010/48200
 No 113/3, New Market Street,
 Choolaimedu High Road, Chennai - 54

